

## The fastest installation in gypsum plasterboard



### BUILDING MATERIALS

- Gypsum plasterboard, single and double-planked

### APPROVALS



### ADVANTAGES

- Produced with at least 50% renewable raw materials and therefore particularly environmentally friendly.
- Just as effective, secure and durable as regular GK plugs.
- The included setting tool combine the functions of drilling and setting fixings for direct and easy installation.
- Fast and power-saving installation using an electric screwdriver.
- Sharp, self-tapping thread for a positive-fit connection with a high load-bearing capacity.
- The cross-drive recess in the head of the fixing means that the GK GREEN can also easily be screwed out like a screw.
- The GK GREEN can be used with various screws, hooks and eye screws, making it very versatile in its applications.

### APPLICATIONS

- Ideal for:**
- Series installations

### APPLICATIONS

- Ideal for:**
- Series installations

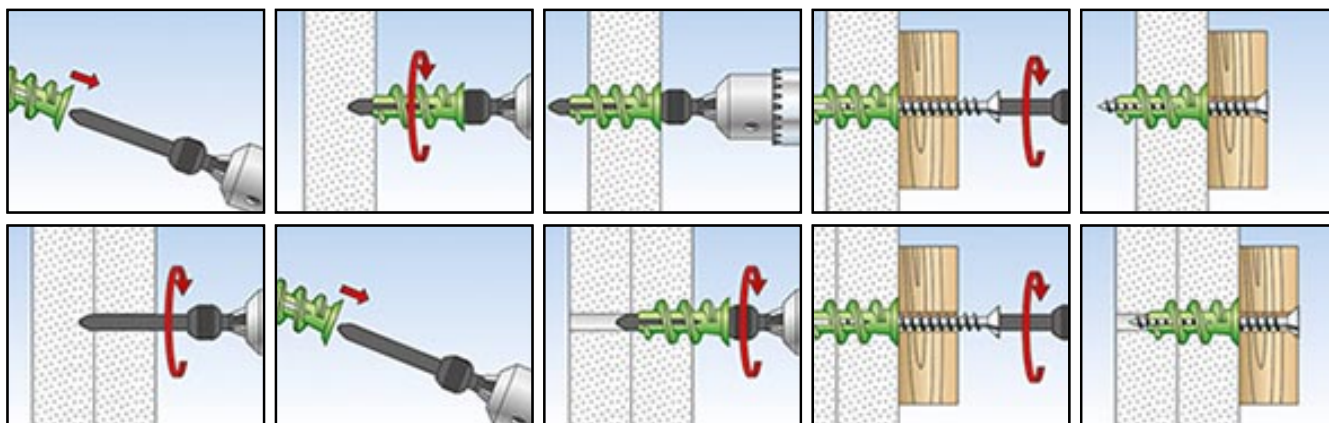

## TECHNICAL DATA



Plasterboard fixing GK GREEN

Article name	Art.-No.	Anchor length l [mm]	Min. thickness to first supporting layer t [mm]	Max. fixture thickness t <sub>fix</sub> [mm]	Screw d <sub>s</sub> x l <sub>s</sub> [mm]	Sales unit [pcs]
<b>GK GREEN</b>	<b>524868</b>	22	25		4,0 - 5,0 x Ls	90
<b>GK GREEN S</b>	<b>524869</b>	22	25	13	4,5 x 35	45

## LOADS

### Plasterboard fixing GK GREEN

Highest recommended loads<sup>1)</sup> for a single anchor.

The given loads are valid for chipboard screws with the specified diameters.

Type			GK GREEN
Chipboard screw	Ø	[mm]	4,0 - 5,0
<b>Recommended loads in the respective base material F<sub>rec</sub></b> <sup>2)</sup>			
Gypsum plasterboard	9,5 mm	[kN]	0,07
Gypsum plasterboard	12,5 mm	[kN]	0,08
Gypsum plasterboard	2 x 12,5 mm	[kN]	0,11

<sup>1)</sup> Required safety factors are considered.

<sup>2)</sup> Valid for tensile load, shear load and oblique load under any angle.